

KEY		BRICK
		CONCRETE
		WOOD

RESIDENCES AT OAK BAY JUNCTION
 FOR J. T. Mc DONALD ESQ
 SCALE. 1/4" = 1 FOOT

H. S. GRIFFITH
 ARCHITECT.
 VICTORIA.

DRAWN
 R. G. R. JUNE 1912

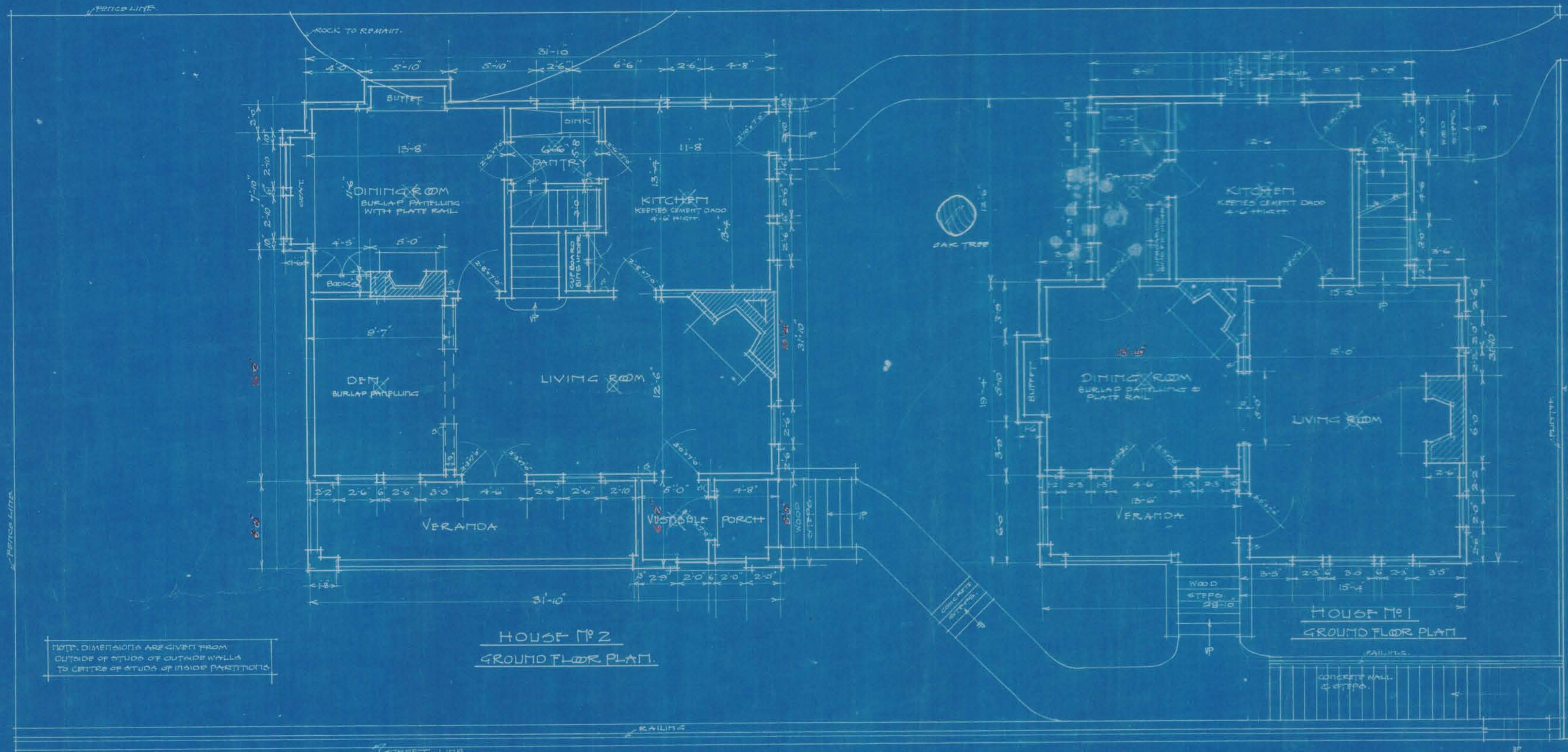

NOTE: DIMENSIONS ARE GIVEN FROM OUTSIDE OF STUDS OF OUTSIDE WALLS TO CENTRE OF STUDS OF INSIDE PARTITIONS

HOUSE NO 2
 GROUND FLOOR PLAN.

HOUSE NO 1
 GROUND FLOOR PLAN

